

# LimniDB-CAP<sup>®</sup>

Capacitive Pressure Transmitter  
for Level Measurements



# LimniDB<sup>®</sup>-CAP

Water level sensor



## APPLICATIONS



Hydrology



Meteorology



Agrometeorology



Sun



Wind

## OVERVIEW

The **LimniDB<sup>®</sup>-CAP** measures the pressure through a ceramic capacitive element making it very robust without any degrading of its metrological qualities. It has two types of signal output: 4-20mA and RS-485 being possible to convert to SDI-12. Available in absolute and relative pressure.

## SPECIFICATIONS

### Measurement Range<sup>(1)</sup>

0 to 20 mH<sub>2</sub>O (water column in meter)

### Resolution

0,001 mH<sub>2</sub>O (1 mm)

### Operation Temperature Range

-40 to 80 °C

### Compensated temperature range

-20 to 80 °C

### Maximum accuracy<sup>(2)</sup>

± 0,1 % F.E. @ -10 to 60°C

### Protection

IP68

### Supply Voltage

8 to 28 Vcc

### Consumption

8 mA max (more loop of 4 to 20 mA)

### Digital Output

RS-485

### Output (optional)<sup>(3)</sup>

SDI-12

### Units

cmH<sub>2</sub>O (water column in centimeters),  
mH<sub>2</sub>O, ft, mBar and PSI.

## PRODUCT DETAILS

- 316L stainless steel body;
- Temperature compensated capacitive ceramic sensor;
- Analog and digital RS-485 signal outputs;
- Available SDI-12 signal output
- Polyurethane cable with UV filter and Kevlar;
- Customized cable size;
- Type of measurement available: absolute or relative.

**NOTE:** 1 - Available in other ranges; 2 - Range factor k=2 to a confidence level of 95%;  
3 - It can be supplied with SDI-12 digital output upon request, but it is not possible to use RS-485 and SDI-12 simultaneously

- **LimniDB<sup>®</sup>-CAP-A:** Absolute Pressure. Requires a barometer to compensate for atmospheric pressure;
- **LimniDB<sup>®</sup>-CAP-D:** Relative Pressure. The atmospheric pressure is compensated by a venting capillary tube with in the electric cable.
- **LimniDB<sup>®</sup>-CAP-E:** Available in special versions. To order please contact us.



Features may change without prior notice. Mar/2019

## DIMENSIONS

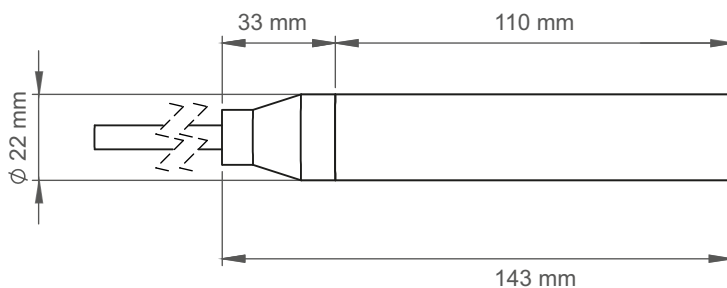

## MANUFACTURER



**Manufacturer:** Dualbase Tecnologia Eletrônica LTDA.  
**Brand:** Dualbase  
**Model:** LimniDB<sup>®</sup>-CAP  
**Type:** Capacitive Pressure Transmitter for Level Measurements

## REPRESENTATIVE